

SX3ST OSCILLATOR



Specifications

Parameters	Standard	Options
Frequency range	10,0 MHz - 52,0 MHz	
Logic output	Clipped sinewave	Sinewave
Frequency stability		
Overall		
Initial at 25°C	+ - 0,5 ppm	Other on custom request
Temperature	+ - 2,5 ppm	Other on custom request
vs supply voltage change	+ - 0,2 ppm	Other on custom request
vs load change		
Aging first year	+ -1,0ppm	Other on custom request
Aging over Years		
Operating temperature	-20°C ~ +75°C	-40°C ~ +85°C
		Other on custom request
Storage temperature	-40°C ~ +85°C	-55°C ~ +125°C
Supply voltage	3,3 V +-5%	5,0 V ± 5% ;3,0 V ±5% ;2,8V ±5%
		Other on custom request
Current	2,0 mA max	
Load	10 Kohm // 10 pF	Other on custom request
Jitter	Please specify (if required)	
Phase noise		
Harmonics		
Sub-harmonics		
Start-up time	4 ms max.	
Marking	Freq + Code + Week +Year	

SX3ST OSCILLATOR

Specifications

Voltage Control Option

External control voltage	+ 1,65 VDC \pm 1,65 VDC (3,3V) +2,5 VDC \pm 2,5 VDC (5,0V)	Other on custom request (depends on supply voltage)
Linearity	\pm 10% max.	
Frequency tuning range	\pm 5 ppm ~ \pm 15 ppm	Other on custom request
Pulling slope	Positive	

Drawing

Package	SX3 4pad	
---------	----------	--

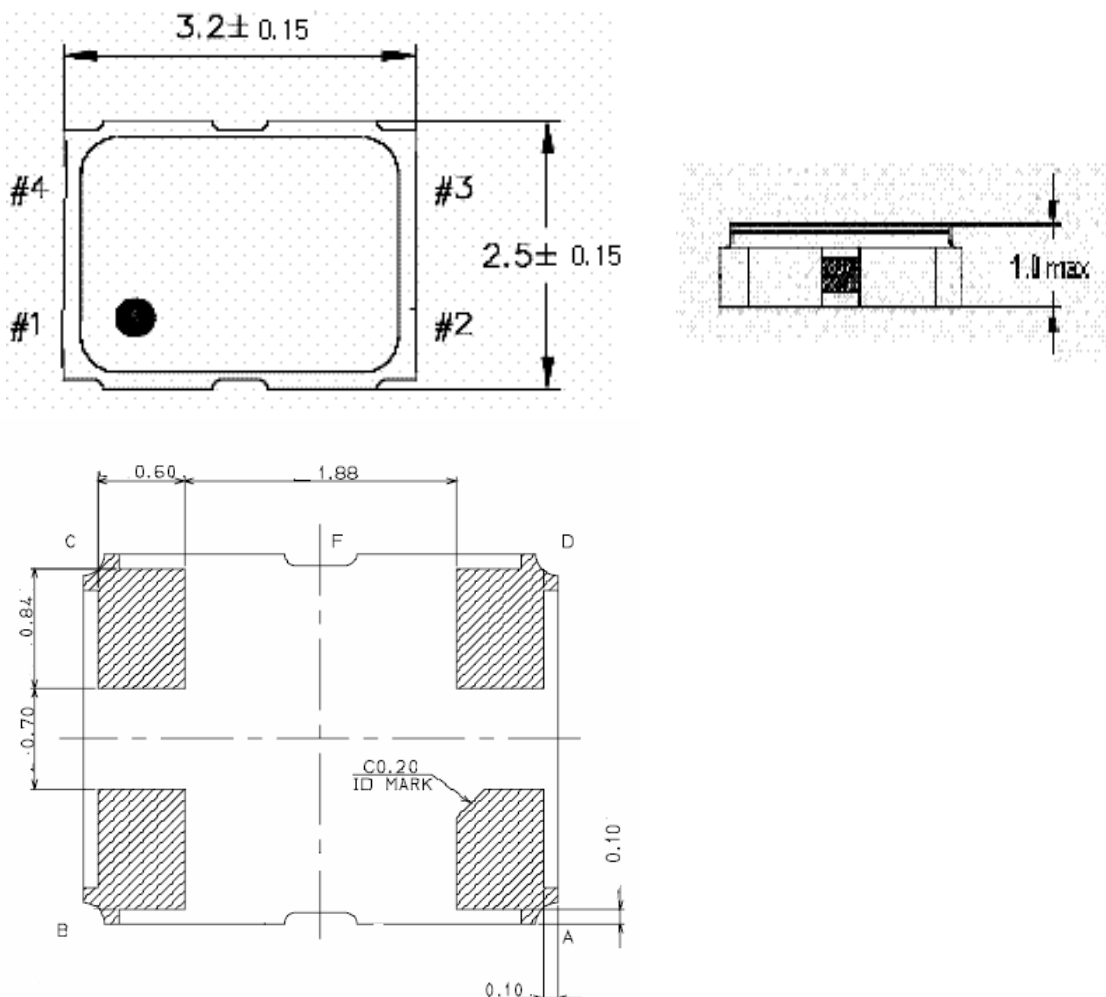

Pin configuration	#1 : NC / Vco	
	#2 : GND	
	#3 : Output	
	#4 : Vcc	